

Operational Manual

True Day & Night IR Color Camera



*If it is for an outdoor application, you need to put it in a housing and turn off the LED light to avoid the reflection.

Please read the Operational Manual before attempting to use this product.

FEATURES

- 1/3" Sony Super HAD CCD
- 420 TV Lines
- Built-in 10 IR LED
- 3.8mm~9.0mm Aspherical Vari-Focal Lens
Auto Iris IR D&N Lens – Made in Japan
- 0.45 Lux @ F1.2
- Indoor IR Distance up to 40ft / 12m
- Mechanical IR Cut Filter / True Day & Night
- 12V DC

DIMENSIONS (Unit: mm)

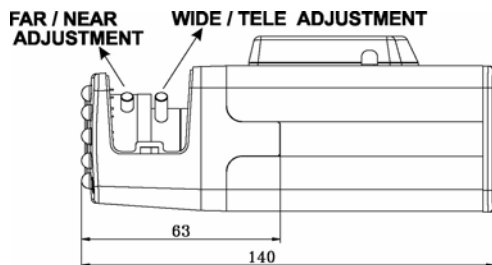
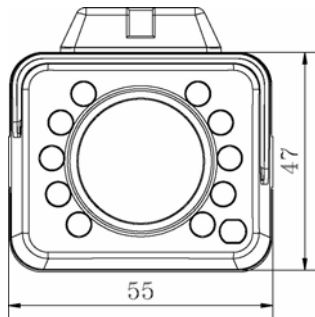

1. Lens Adjustment

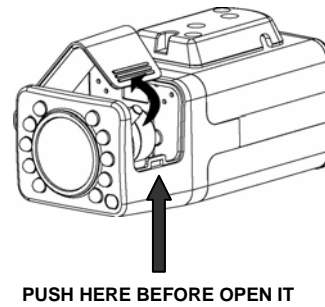

2. IR LED On / Off

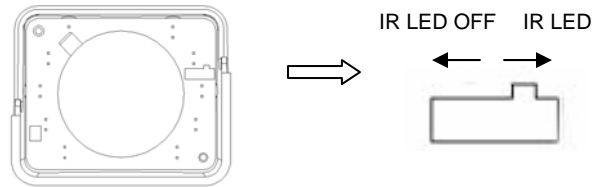

3. Description of Function

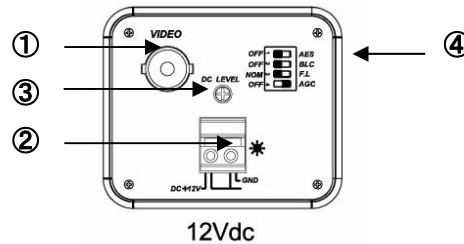

1. Video Connector
2. Power Input
3. Vari-Focal Lens Level Adjustment
4. Control Switch



SW1. AES: Auto Electronic Shutter OFF / ON Switch
 SW2. BLC: Back Light Compensation OFF / ON Switch
 SW3. FL: Flickerless NOM / FL Switch
 SW4. AGC: Automatic Gain Control OFF / ON Switch

CAMERA MOUNTING

The camera can be attached to a tripod fixer or other mounting device from either the top or bottom side by using the mounting screw holes (1/4-inch, 20UNC) of the tripod set base plate.

CAUTION: The tripod set base plate is moved by removing the two screws first and then attaching the base plate to the top(or bottom). Do not use any screws other than those of the tripod set base plate of this camera. Use of longer screws can cause the camera to be damaged.

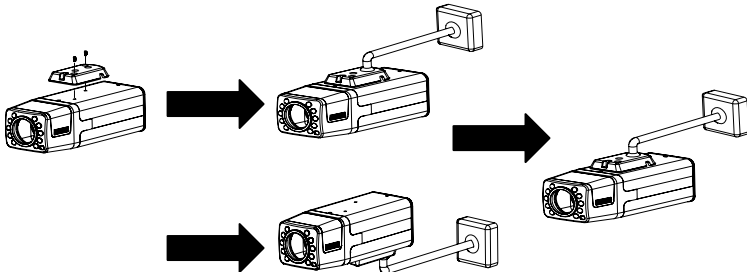

SPECIFICATION

Model	SSM-742AII	SSM-742AII P
TV System	NTSC	PAL
Image Sensor	1/3" Sony Super HAD CCD	
DSP	Sony	
Total Pixels	537(H)×505(V)	537(H)×597(V)
Synchronization	Internal	
Video Output	1.0Vp-p composite / 75ohms	
Resolution	420 TV Lines	
Minimum Illumination	0.45 Lux @ F1.2 Controlled by a CDS sensor	
Day/Night Switching	Mechanical IR Cut Filter	
S/N Ratio	More than 48dB (AGC OFF)	
Auto Electronic Shutter	ON/OFF Switchable	
Back Light Compensation	ON/OFF Switchable	
Flickerless	ON/OFF Switchable	
Auto Gain Control	ON/OFF Switchable	
Auto White Balance	ATW	
IR LED	Built-in 10 IR LED	
IR Distance (Indoor)	Up to 40ft / 12m	
Lead Free	N/A	
Lens	3.8mm~9.0mm Aspherical Vari-Focal Lens Auto Iris IR D&N Lens – Made in Japan	
Power Supply	12V DC	
Power Consumption	3.5 Amp	
Operation Temperature	-10°C ~ +50°C	
Storage Temperature	-20°C ~ +60°C	
Storage Humidity	RH85% or less	
Dimensions	55mm(W) x 47mm(H) x 140mm(L)	
Weight	300g	

*Specifications are subject to change without notice

PACKAGE CONTENTS

- One (1) SSM-742AII/SSM-742AII P Camera with video/power cable
- One (1) Operational Manual

* For any returns, please include all components listed above with original packaging in **Resalable Condition**. **Absolutely No Returns** will be accepted if any component is missing/damaged or if any cable is cut or tampered with.



CAUTIONS

- 1. Never point the camera toward the sun**
Do not expose the lens directly to the sun or to strong light as this may damage the pick-up device.
- 2. Handle this camera with care**
Avoid any shock or bumping of the camera. Improper handling could damage the camera.
- 3. Requires a proper operating environment**
This camera is designed for outdoor or indoor use. The allowable temperature range for operation of this camera is between -10°C ~ 50°C and the allowable humidity is 85%RH maximum.
- 4. Clean the front face to the pick-up device**
It is recommended that the pick-up device surface be cleaned before lens installation or whenever the lens is changed. Cleaning should be done by using a chamois, a very fine soft cloth, lens tissue, or cotton tipped applicator and ethanol to carefully remove any fingerprint or dust.
- 5. Check the power source voltage**
The power source voltage should be within the specified range. (Camera must meet the specifications). Camera must be connected to a surge protector at all times.
- 6. Objects and liquid entry**
Never push objects of any kind into this camera as this may touch dangerous voltage points of short out parts that could result in a fire or electric shock. Never spill any kind of liquid on the video product.
- 7. Servicing**
Do not attempt to service this video product by yourself as opening or removing covers may expose you to dangerous voltage or other hazards. Refer all service to qualified servicing personnel.
- 8. Damage requiring service**
Unplug this video product from the wall outlet and refer service to qualified servicing personnel under the following conditions:
 - a. When the power supply cord or plug is damaged.
 - b. If liquid has been spilled, or objects have fallen into the video product.
 - c. If the video product has been dropped or the cabinet has been damaged.
 - d. When the video product exhibits a distinct change in performance.



WARRANTY

OKINA USA Products are covered under warranty for one year from the date of purchase. The warranty will automatically be voided if any of the following occurs:

- 1. Camera sticker is removed**
If the camera sticker is removed, we will not be able to confirm any information regarding when and where the product was purchased. We have no other way to verify the purchase record without the serial number on the camera sticker; therefore, it should not be removed.
- 2. Camera is modified in any way**
If the camera is scratched, damaged, or modified in a manner not described in this manual, the warranty will be voided immediately. It is the customer's responsibility to keep the camera in good condition.
- 3. Video or power cable is cut**
The video cable and the power cable should not be tampered with. Cutting or modifying of the cables will result in termination of the warranty.