

**Operational Manual**

**Day & Night Bullet Color Camera**



Please read the Operational Manual before attempting to use this product.

**FEATURES**

- 1/3" Sony Super HAD II CCD
- 540 TV Lines, HQ-1 DSP
- 3.6mm Board Lens
- 0.15 Lux @ F2.0
- Long life and high reliability are achieved by the use of a CCD image device. This makes the camera 100% solid state.
- Ease of use in any application is achieved through the small size.
- IP67 Rating – Can be used for indoor/outdoor
- 12V DC, Max. 130mA

**DIMENSIONS (Unit: mm)**

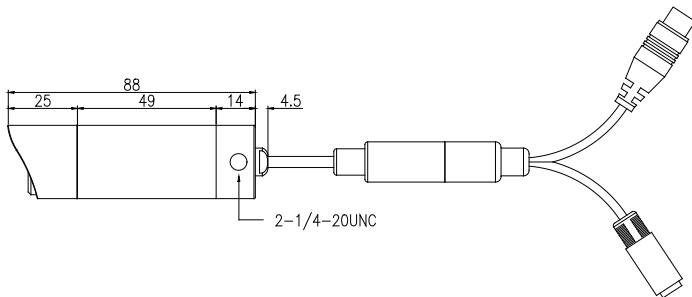

**PARTS AND FUNCTIONS**

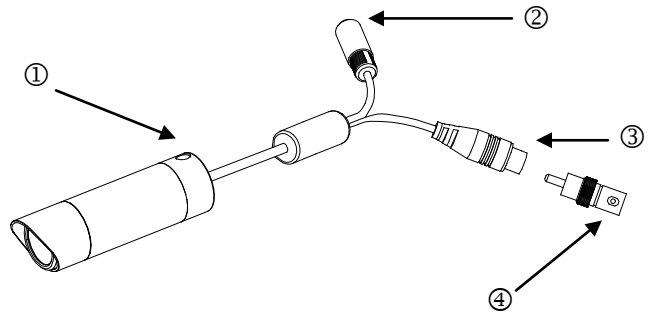

- ① **Camera mounting screw hole**  
Screw hole for fixing camera.
- ② **Power input terminal**  
Connect the power supply of 12V DC.
- ③ **RCA terminal (Yellow)**  
This is a video output for connecting to a video monitor, etc. (75Ω).
- ④ **BNC video connector**  
This is a video connector to connect the RCA terminal to a BNC video monitor.

**SPECIFICATIONS**

Model	SHB-7540DN	SHB-7540DNP
TV System	NTSC	PAL
Image Sensor	1/3" Sony Super HAD II CCD	
DSP	Sony HQ-1	
Total Pixels	811(H) x 508(V)	795(H) x 596(V)
Synchronization	Internal	
Resolution	540 TV Lines	
Video Output	1.0Vp-p / 75Ω	
Scanning System	2:1 Interlace	
Gamma Correction	0.45	
Minimum Illumination	0.15 Lux @ F2.0	
S/N Ratio	More than 50dB	
Day & Night	Color / D&N	
Auto Gain Control	Auto	
Back Light Compensation	Auto	
Electronic Shutter Speed	1/60~1/100,000s	1/50~1/100,000s
Lens	3.6mm Board Lens / F2.0, 72.5°	
Power Supply	12V DC	
Power Consumption	130mA / 1.6W	
IP Rating	IP67	
Operation Temperature	14°F~122°F / -10°C~50°C	
Storage Temperature	-4°F~140°F / -20°C~60°C	
Storage Humidity	Max. RH90%	
Dimensions	3.48"(L) x 1.04"(Ø) 88.39 (L) x 26.4 (Ø) mm	
Weight	0.44 lbs / 200g	

\*Specifications are subject to change without notice

## PACKAGE CONTENTS

- One (1) SHB-7540DN/SHB-7540DNP Camera with video/power cable
- One (1) Mounting Bracket
- Three (3) Mounting Screws
- Three (3) Wall Anchors
- One (1) Video Connector
- One (1) Spacer
- One (1) Operational Manual

\* For any returns, please include all components listed above with original packaging in **Resalable Condition**. **Absolutely No Returns** will be accepted if any component is missing/damaged or if any cable is cut or tampered with.



## CAUTION

### 1. Never point the camera toward the sun

Do not expose the lens directly to the sun or to strong light as this may damage the pick-up device.

### 2. Handle this camera with care

Avoid any shock or bumping of the camera. Improper handling could damage the camera.

### 3. Requires a proper operating environment

This camera is designed for indoor and outdoor use. The allowable temperature range for operation of this camera is between 14°F~122°F / -10°C~50°C and the allowable humidity is 90%RH maximum.

### 4. Clean the front face to the pick-up device

It is recommended that the pick-up device surface be cleaned before lens installation or whenever the lens is changed. Cleaning should be done by using a chamois, a very fine soft cloth, lens tissue, or cotton tipped applicator and ethanol to carefully remove any fingerprint or dust.

### 5. Check the power source voltage

The power source voltage should be within the specified range. (Camera must meet the specifications). Camera must be connected to a surge protector at all times.

### 6. Objects and liquid entry

Never push objects of any kind into this camera as this may touch dangerous voltage points of short out parts that could result in a fire or electric shock. Never spill any kind of liquid on the video product.

### 7. Servicing

Do not attempt to service this video product by yourself as opening or removing covers may expose you to dangerous voltage or other hazards. Refer all service to qualified servicing personnel.

## 8. Damage requiring service

Unplug this video product from the wall outlet and refer service to qualified servicing personnel under the following conditions:

- a. When the power supply cord or plug is damaged.
- b. If liquid has been spilled, or objects have fallen into the video product.
- c. If the video product has been exposed to rain or water.
- d. If the video product has been dropped or the cabinet has been damaged.
- e. When the video product exhibits a distinct change in performance.



## WARRANTY

OKINA USA products are covered under warranty for one year from the date of purchase. The warranty will automatically be voided if any of the following occurs:

### 1. Camera sticker is removed

If the camera sticker is removed, we will not be able to confirm any information regarding when and where the product was purchased. We have no other way to verify the purchase record without the serial number on the camera sticker; therefore, it should not be removed.

### 2. Camera is modified in any way

If the camera is scratched, damaged, or modified in a manner not described in this manual, the warranty will be voided immediately. It is the customer's responsibility to keep the camera in good condition.

### 3. Video or power cable is cut

The video cable and the power cable should not be tampered with. Cutting or modifying of the cables will result in termination of the warranty.