

HUB-TS
HUB-TSHB



HUB-TS



HUB-TSHB

- Constructed from die-cast aluminum alloy and is powder coated with stove finish
- IP68 Rating -- designed and manufactured to the highest technical standard with environmental protection
- Fully-Cable Managed Bracket
- Uses professional rust-proof stainless steel screws
- Includes Heater & Blower for HUB-TSHB
- 24V AC, 40VA



GENERAL SPECIFICATIONS

CE  RoHS Made in Taiwan

Model Number	HUB-TS	HUB-TSHB
IP Rating	IP68	
Mounting Bracket	Full-Cable Management	
Construction	Die-Cast Aluminum Alloy	
Coating	Ivory Powder Stove	
Heater	No	Yes
Blower	No	Yes
Required Power Supply / Transformer *	No	24V AC (+/-10%), 40VA
Dimension	15.94(L) x 5.91(W) x 5.91(H) in. / 405(L) x 150(W) x 150(H) mm	
Weight	7.28 lbs / 3300g (with bracket)	8.16 lbs / 3700g (with bracket)

* Power supply / transformer not included

** Specifications and appearance are subject to change without notice

DIMENSIONS

HUB-TS / HUB-TSHB:



Full-Cable Managed Bracket:

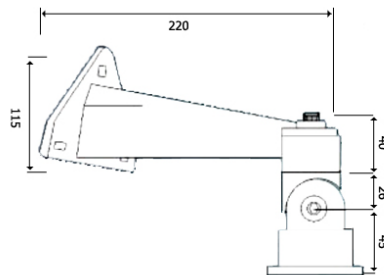

HUB-TS



HUB-TSHB



*** UL certification only refers to the power converter and the power module